

**DRIVE SCREWS
TYPE U
ROUND HEAD**

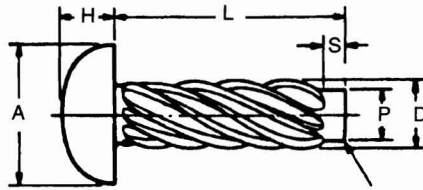

| Nominal Screw Size | Number of Thread Starts | D | | A | | H | | P | | Recommended Hole Size | |
|--------------------|-------------------------|------------------|-------|---------------|-------|-------------|-------|----------------|-------|-----------------------|---------------|
| | | Outside Diameter | | Head Diameter | | Head Height | | Pilot Diameter | | Drill Size No. | Hole Diameter |
| | | Max | Min | Max | Min | Max | Min | Max | Min | | |
| 00 | 6 | 0.060 | 0.057 | 0.099 | 0.090 | 0.034 | 0.026 | 0.049 | 0.046 | 55 | 0.052 |
| 0 | 6 | 0.075 | 0.072 | 0.127 | 0.118 | 0.049 | 0.041 | 0.063 | 0.060 | 51 | 0.067 |
| 2 | 8 | 0.100 | 0.097 | 0.162 | 0.146 | 0.069 | 0.059 | 0.083 | 0.080 | 44 | 0.086 |
| 4 | 7 | 0.116 | 0.112 | 0.211 | 0.193 | 0.086 | 0.075 | 0.096 | 0.092 | 37 | 0.104 |
| 6 | 7 | 0.140 | 0.136 | 0.260 | 0.240 | 0.103 | 0.091 | 0.116 | 0.112 | 31 | 0.120 |
| 7 | 8 | 0.154 | 0.150 | 0.285 | 0.264 | 0.111 | 0.099 | 0.126 | 0.122 | 29 | 0.136 |
| 8 | 8 | 0.167 | 0.162 | 0.309 | 0.287 | 0.120 | 0.107 | 0.136 | 0.132 | 27 | 0.144 |
| 10 | 8 | 0.182 | 0.177 | 0.359 | 0.334 | 0.137 | 0.123 | 0.150 | 0.146 | 20 | 0.161 |
| 12 | 8 | 0.212 | 0.206 | 0.408 | 0.382 | 0.153 | 0.139 | 0.177 | 0.173 | 11 | 0.191 |
| 14 | 9 | 0.236 | 0.242 | 0.457 | 0.429 | 0.170 | 0.155 | 0.202 | 0.198 | 2 | 0.221 |
| L | Nominal Screw Length | 1/8 | 3/16 | 1/4 | 5/16 | 3/8 | 1/2 | 5/8 | 3/4 | 1" and | |
| S | Pilot Length | 0.047 | 0.047 | 0.047 | 0.047 | 0.062 | 0.062 | 0.078 | 0.078 | 0.125 | |

COTTER PINS

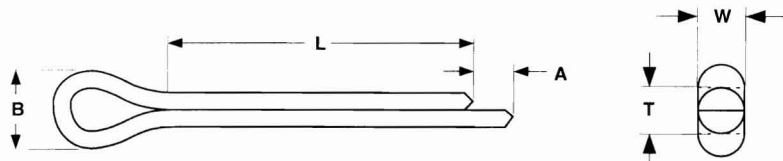

| Nominal Size | Basic Pin Diameter | T | | W | | B | A | Gage Hole Diameter (±0.001) |
|--------------|--------------------|----------------------|-------|------------|-------|---------------|-----------------------|-----------------------------|
| | | Total Shank Diameter | | Wire Width | | Head Diameter | Extended Prong Length | |
| | | Max | Min | Max | Min | Min | Min | |
| 1/16 | 0.062 | 0.060 | 0.056 | 0.060 | 0.044 | 0.12 | 0.03 | 0.078 |
| 3/32 | 0.094 | 0.090 | 0.086 | 0.090 | 0.069 | 0.19 | 0.04 | 0.109 |
| 1/8 | 0.125 | 0.120 | 0.116 | 0.120 | 0.093 | 0.25 | 0.06 | 0.141 |
| 5/32 | 0.156 | 0.150 | 0.146 | 0.150 | 0.116 | 0.31 | 0.07 | 0.172 |
| 3/16 | 0.188 | 0.176 | 0.172 | 0.176 | 0.137 | 0.38 | 0.09 | 0.203 |
| 7/32 | 0.219 | 0.207 | 0.202 | 0.207 | 0.161 | 0.44 | 0.10 | 0.234 |
| 1/4 | 0.250 | 0.225 | 0.220 | 0.225 | 0.176 | 0.50 | 0.11 | 0.266 |
| 5/16 | 0.312 | 0.280 | 0.275 | 0.280 | 0.220 | 0.62 | 0.14 | 0.312 |
| 3/8 | 0.375 | 0.335 | 0.329 | 0.335 | 0.263 | 0.75 | 0.16 | 0.375 |
| 1/2 | 0.500 | 0.473 | 0.467 | 0.473 | 0.373 | 1.00 | 0.23 | 0.500 |