

HEX SOCKET
SHOULDER SCREWS

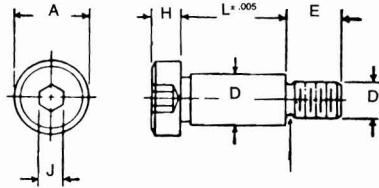

Nominal Size or Basic Shoulder Diameter	D		A		H		D		E	I	J			
	Shoulder Diameter		Head Diameter		Head Height		Nominal Thread Size or Basic Thread Diameter	Threads Per Inch	Thread Length	Thread Neck Width	Hexagon Socket Size			
	Max	Min	Max	Min	Max	Min			Basic	Max	Nom			
1/4	0.250	0.2480	0.2460	0.375	0.357	0.188	0.177	10	0.1900	24	0.375	0.062	1/8	0.125
5/16	0.312	0.3105	0.3085	0.438	0.419	0.219	0.209	1/4	0.2500	20	0.438	0.075	5/32	0.156
3/8	0.375	0.3730	0.3710	0.562	0.543	0.250	0.240	5/16	0.3125	18	0.500	0.083	3/16	0.188
1/2	0.500	0.4980	0.4960	0.750	0.729	0.312	0.302	3/8	0.3750	16	0.625	0.093	1/4	0.250
5/8	0.625	0.6230	0.6210	0.875	0.853	0.375	0.365	1/2	0.5000	13	0.750	0.115	5/16	0.312
3/4	0.750	0.7480	0.7460	1.000	0.977	0.500	0.490	5/8	0.6250	11	0.875	0.136	3/8	0.375
1	1.000	0.9980	0.9960	1.312	1.287	0.625	0.610	3/4	0.7500	10	1.000	0.150	1/2	0.500

HEX
SOCKET
SET
SCREWS

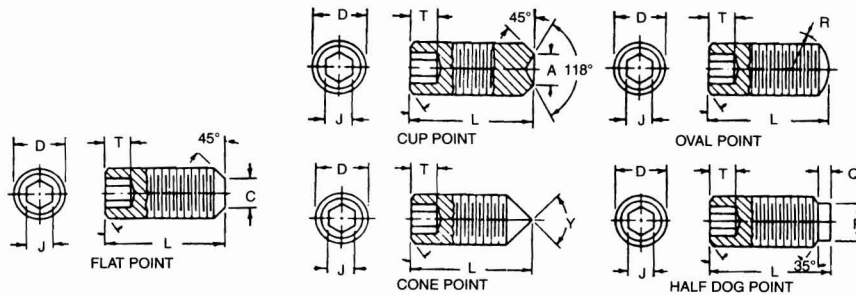

Nominal Diameter	A		R	Y	P		Q	J	T	Shorest Length to which Column T Applies
	Cup and Flat Point Diameter		Oval Point Radius	Cone Point Angle 90±2 For These Lengths and Over	Half Dog Point		Length Nom.	Socket Width Across Flats	Key Engagement	
	Max	Min			Max	Min		Nom	Min	
0	0.033	0.027	0.045	5/64	0.040	0.037	0.015	0.028	0.050	7/64
1	0.040	0.033	0.055	3/32	0.049	0.045	0.019	0.035	0.060	1/8
2	0.047	0.039	0.064	7/64	0.057	0.053	0.022	0.035	0.060	1/8
3	0.054	0.045	0.074	1/8	0.066	0.062	0.025	0.050	0.070	9/64
4	0.061	0.051	0.084	5/32	0.075	0.070	0.028	0.050	0.070	9/64
5	0.067	0.057	0.094	3/16	0.083	0.078	0.030	1/16	0.080	3/16
6	0.074	0.064	0.104	3/16	0.092	0.087	0.035	1/16	0.080	11/64
8	0.087	0.076	0.123	1/4	0.109	0.103	0.040	5/64	0.090	3/16
10	0.102	0.088	0.142	1/4	0.127	0.120	0.045	3/32	0.100	3/16
1/4	0.132	0.118	0.188	5/16	5/32	0.149	1/16	1/8	0.125	1/4
5/16	0.172	0.156	0.234	3/8	13/64	0.195	5/64	5/32	0.156	5/16
3/8	0.212	0.194	0.281	7/16	1/4	0.241	3/32	3/16	0.188	3/8
7/16	0.252	0.232	0.328	1/2	19/64	0.287	7/64	7/32	0.219	7/16
1/2	0.291	0.270	0.375	9/16	11/32	0.334	1/8	1/4	0.250	1/2
5/8	0.371	0.347	0.469	3/4	15/32	0.456	5/32	5/16	0.312	5/8
3/4	0.450	0.425	0.562	7/8	9/16	0.549	3/16	3/8	0.375	3/4
7/8	0.530	0.502	0.656	1	21/32	0.642	7/32	1/2	0.500	7/8
1	0.609	0.579	0.750	1 1/8	3/4	0.734	1/4	9/16	0.562	1